

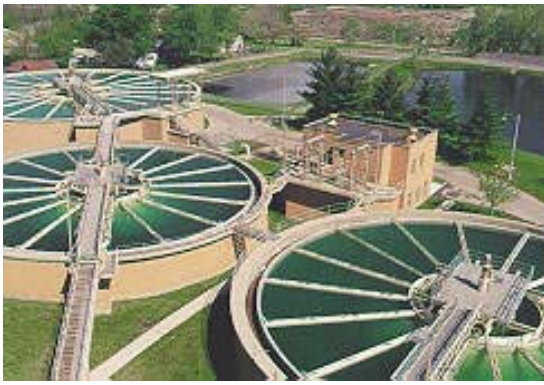

Contents

WASTE WATER TREATMENT	88
OFFLAUGER	88
GENERAL PLASTIC BELT CONVEYOR	89
METAL DETECTORS	89
RAMSEY SCALE	90



WASTE WATER TREATMENT



Dewatering and screw conveyor

	Original Bearing	EDT Bearing
Bearing	Cast iron housing with standard ball bearings	Poly-Round® Solution® - Polymer or stainless housing, solid polymer bearing, and stainless locking sleeve
Failure	Seals breakdown, grease washes out, doesn't turn enough for proper rolling element operation, outside contaminants affect bearing	Eventually ID of bearing will get too large to maintain centerline. Bearing and shaft life is greatly extended by using an EDT stainless locking sleeve
Length of Service	Varies depending on waste chemistry - 1 to 6 months	1 to 3 years
Maintenance Required	Rely on seals to retain grease in submerged locations Particulates in water can ruin seals and cause bearing failure	Zero maintenance required after installation
Features & Benefits	Original equipment component Low purchase price	Plane bearings, depending on material, are unaffected by waste contaminants Plane bearings do not need to fully rotate for satisfactory and consistent service over time Cost of ownership is lower due to longevity of operation without additional maintenance expense



OFFAL AUGER



QF4GL9-3

Idle end of auger

	Original Bearing	EDT Bearing
Bearing	Type E 4-bolt flange cast iron housing and carbon steel roller bearing, 2-15/16" or 3" shaft	QF4GL9-3 3-piece stainless & polymer All-Round® bearing in polymer 4-bolt flange housing
Failure	Submersion and exposure to chemicals, feathers, and viscera prematurely fails bearings and rusts housings	StainlessAll-Round® bearings and polymer housings are unaffected by washdown, chemicals, feathers, or viscera
Length of Service	2 weeks to 1 month	8 months to 3 years (typically change at the same time as the screw is replaced)
Maintenance Required	Regular greasing and frequent replacement required due to rust and contaminants. Change out takes 4 hours.	Operates reliably over the lifetime of the screw! Requires no interim maintenance beyond installation
Features & Benefits	Low initial cost.	• Longer life; less frequent changeout • Reliable operation with zero maintenance • Lower cost of ownership



GENERAL PLASTIC BELT CONVEYOR

1 Year
GUARANTEED
Application



NA1GC7-1

Modular Plastic Belt Conveyor

	Original Bearing	EDT Bearing
Bearing	Any style cast iron, nickel plated or composite housing with a ball bearing	NA Poly-Round® Solution® solid polymer bearing insert with locking sleeve in polymer (or stainless) housing
Failure	Caustic wash down rusts cast iron housing and carbon steel insert very quickly, frequent relubrication,	Housings and bearings require NO GREASE, are not affected by caustic wash down, are non-contaminating
Length of Service	1 to 2 months	12+ months (guaranteed application)
Maintenance Required	Regular greasing and constant bearing replacement due to rust; potential product contamination.	Requires no interim maintenance after initial installation
Features & Benefits	Low initial cost.	<ul style="list-style-type: none"> • Longer life reduces maintenance cycles • Low <i>total</i> cost of ownership • Reliable operation with zero maintenance • Higher level of sanitation



1 Year
GUARANTEED
Application

METAL DETECTORS

(Safeline, Cintex, Loma, Goering Kerr)



Modular Plastic Belt Carry-through Conveyor

	Original Bearing	EDT Bearing
Bearing	Nickel plated housing with carbon steel ball bearing	Poly-Round® Solution® polymer (or stainless) housing with solid polymer insert and locking sleeve
Failure	Caustic wash down rusts cast iron housing and carbon steel insert very quickly	Housings and bearings are not affected by caustic wash down - no rust, no grease, non-conductive
Length of Service	3 months	12+ months (guaranteed application)
Maintenance Required	Regular greasing and frequent bearing replacement due to rust and potential product contamination.	Requires no interim maintenance beyond installation
Features & Benefits	Low initial cost.	<ul style="list-style-type: none"> • Longer life reduces maintenance cycles • Lower <i>total</i> cost of ownership • Reliable operation with zero maintenance • Higher level of sanitation

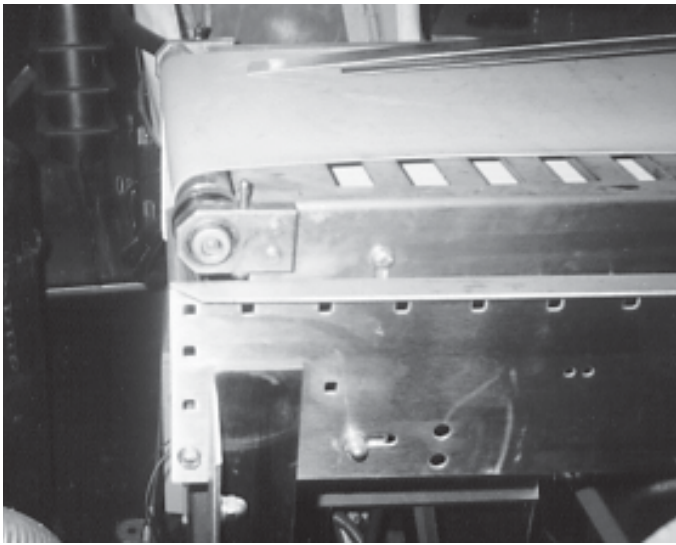

RAMSEY SCALE

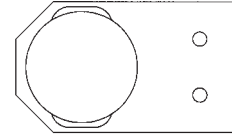

EDT-0108

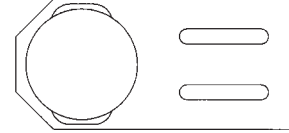

EDT-0109

Flat belt conveyor

	Original Bearing	EDT Bearing
Bearing	Special OEM plastic housing with steel ball bearing	EDT-0108 and EDT-0109: custom stainless housings (option to include stainless ball bearing insert)
Failure	Easy to break housing. OEM housing swells with water, then no longer retains bearing.	Stainless steel housing will not break, not affected by water, washdown or chemicals.
Length of Service	3 to 6 months	1 to 3+ years
Maintenance Required	Regular greasing; rust and potential product contamination; housing life is unpredictable.	Ball bearing requires routine greasing
Features & Benefits	High cost, limited availability, because only source of replacement part is OEM who only offers plastic housing.	Stainless housing is strong and can be 1 time purchase No catastrophic failure