

# MEPSCO INJECTOR



NA3GC7-1

## Modular Plastic Belt Conveyor

	Original Bearing	EDT Bearing
Bearing	Stainless housing with stainless ball bearing	NA3GC7-1 - Solid polymer Poly-Round® with locking sleeve in polymer housing
Failure	Not able to grease bearing trapped inside conveyor Stainless bearings rust when exposed to marinade brine	NA Poly-Round® bearing is not affected by chemical washdown. Polymer bearing does not need greasing; water and chemical won't rust polymer housing.
Length of Service	1-2 Months, or until USDA writes noncompliance report because of rust.	18 - 24 month life average
Maintenance Required	Replacement takes 4 hours because bearings are inside conveyor frame.	Requires no interim maintenance beyond installation
Features & Benefits	Lower initial cost	Longer, more reliable life Won't rust so non-compliance reports decrease Reliable operation over time Longevity & low maintenance = Fewer replacements = Lower cost of ownership

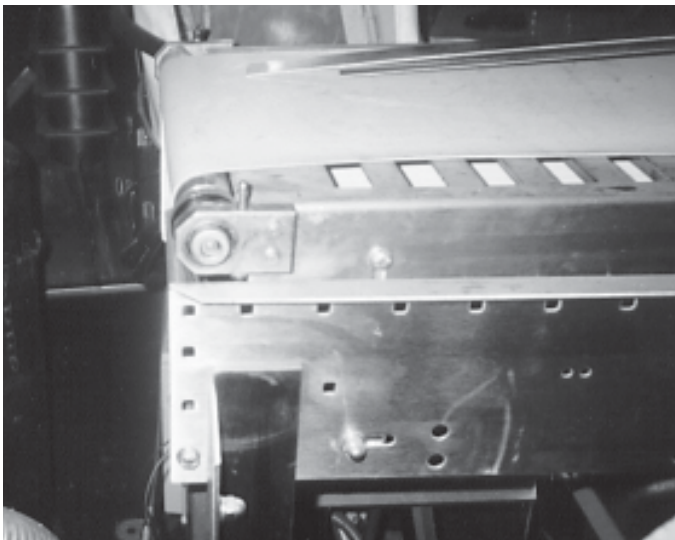

# RAMSEY SCALE

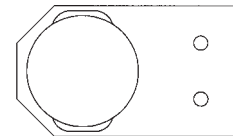

EDT-0108

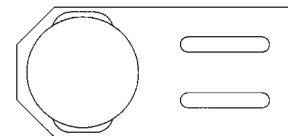

EDT-0109

## Flat belt conveyor

	Original Bearing	EDT Bearing
Bearing	Special OEM plastic housing with steel ball bearing	EDT-0108 and EDT-0109: custom stainless housings (option to include stainless ball bearing insert)
Failure	Easy to break housing. OEM housing swells with water, then no longer retains bearing.	Stainless steel housing will not break, not affected by water, washdown or chemicals.
Length of Service	3 to 6 months	1 to 3+ years
Maintenance Required	Regular greasing; rust and potential product contamination; housing life is unpredictable.	Ball bearing requires routine greasing
Features & Benefits	High cost, limited availability, because only source of replacement part is OEM who only offers plastic housing.	Stainless housing is strong and can be 1 time purchase No catastrophic failure