

GENERAL PLASTIC BELT CONVEYOR



1 Year
GUARANTEED
Application



NA1GC7-1

Modular Plastic Belt Conveyor

	Original Bearing	EDT Bearing
Bearing	Any style cast iron, nickel plated or composite housing with a ball bearing	NA Poly-Round® Solution® solid polymer bearing insert with locking sleeve in polymer (or stainless) housing
Failure	Caustic wash down rusts cast iron housing and carbon steel insert very quickly, frequent relubrication,	Housings and bearings require NO GREASE, are not affected by caustic wash down, are non-contaminating
Length of Service	1 to 2 months	12+ months (guaranteed application)
Maintenance Required	Regular greasing and constant bearing replacement due to rust; potential product contamination.	Requires no interim maintenance after initial installation
Features & Benefits	Low initial cost.	<ul style="list-style-type: none"> • Longer life reduces maintenance cycles • Lower <i>total</i> cost of ownership • Reliable operation with zero maintenance • Higher level of sanitation

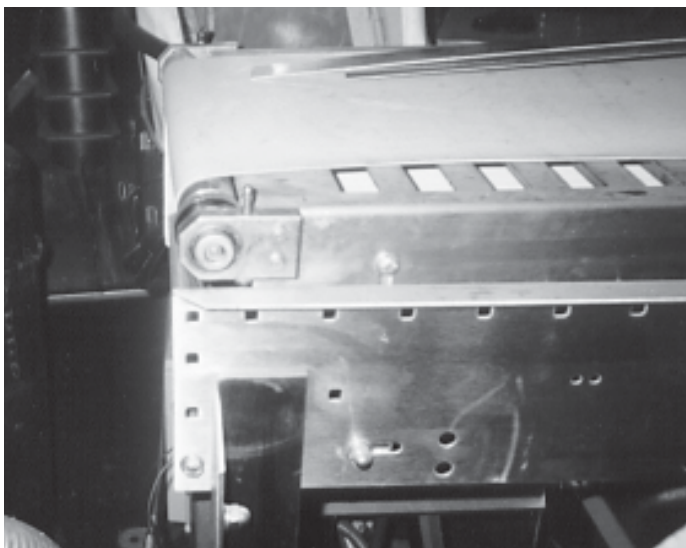

RAMSEY SCALE

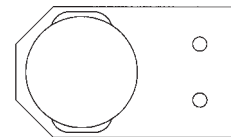

EDT-0108

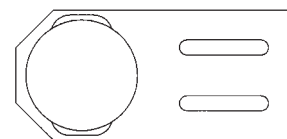

EDT-0109

Flat belt conveyor

	Original Bearing	EDT Bearing
Bearing	Special OEM plastic housing with steel ball bearing	EDT-0108 and EDT-0109: custom stainless housings (option to include stainless ball bearing insert)
Failure	Easy to break housing. OEM housing swells with water, then no longer retains bearing.	Stainless steel housing will not break, not affected by water, washdown or chemicals.
Length of Service	3 to 6 months	1 to 3+ years
Maintenance Required	Regular greasing; rust and potential product contamination; housing life is unpredictable.	Ball bearing requires routine greasing
Features & Benefits	High cost, limited availability, because only source of replacement part is OEM who only offers plastic housing.	Stainless housing is strong and can be 1 time purchase No catastrophic failure