



HEAT & CONTROL FRYER BEARINGS



Paddle and belt conveyor FAIUD71-3/16_

FA2AD7-3/16

	Original Bearing	EDT Bearing
Bearing	Metal ball bearing in cast iron housing (typically, a 2-bolt flange housing), but manufacturer will upgrade to EDT bearings on request	FAIUD7-1-3/16, FAIUE7-1-7/16, FAIUC7-1, FAIUG7-1-11/16 and other sizes: FA material Poly-Round® is high temperature, direct food contact approved. Mates with stainless locking sleeve, install bearing insert into an existing housing or into any style stainless housing
Failure	Ball bearing does not operate well submerged in hot oil; grease runs out, congeals, and fryer fines can restrict balls from rolling. Potential for catastrophic bearing failure.	Poly-Round® insert bearing has no rolling elements. Needs no grease, has no moving parts. FA material is approved for direct- and continuous- food contact. FA tolerates temperatures to 500°F.
Length of Service	3 to 8 months	12 to 18 months (guaranteed application)
Maintenance Required	When tanks are drained, all bearings must be checked. Cast housings are prone to rust when not submerged; rust, excess grease, broken bearings can contaminate the cooking oil.	<ul style="list-style-type: none"> • Unaffected by oil - plane bearings operate consistently from start-up to start-up regardless of downtime • Optional stainless housing will not rust and contaminate edible oil
Features & Benefits	Low initial cost.	<ul style="list-style-type: none"> • Long and reliable service with no maintenance • No catastrophic failure resulting in lost product • Eliminate causes of possible product contamination • Lower cost of ownership

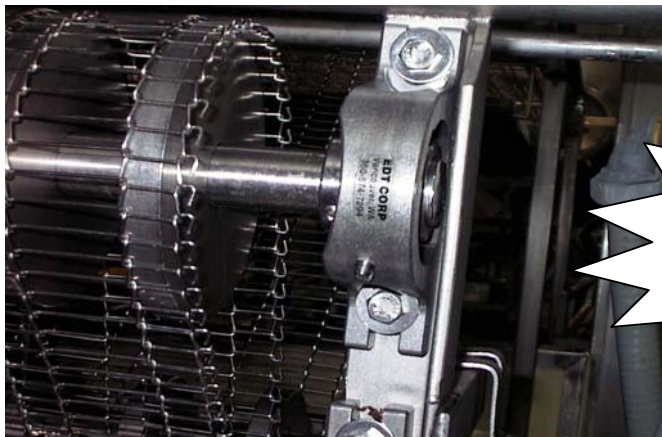

STEIN JSO OVEN BEARINGS

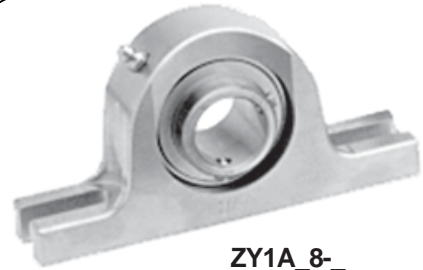

ZY1A_8_

Wire belt Conveyor

	Original Bearing	EDT Bearing
Bearing	Cast iron pillow blocks with carbon steel inserts	ZY1AF8-1-1/2 or ZY1AG8-1-3/4; Stainless ball bearing in a stainless pillow block housing
Failure	High temperature depletes grease rapidly. Caustic washdown rusts cast iron housings and carbon steel inserts very quickly. Edible product can contact rusty parts.	Stainless housings are less affected by caustic washdown, smooth surfaces do not trap bacteria; No contamination from rust.
Length of Service	3 weeks to 4 months	12+ months (guaranteed application)
Maintenance Required	Frequent greasing	Requires infrequent greasing. Bearing will eventually need to be changed out, but housing can be a 1 time purchase.
Features & Benefits	Low initial cost	<ul style="list-style-type: none"> • Longer life reduces maintenance cycles • Lower total cost of ownership • Improved level of sanitation