

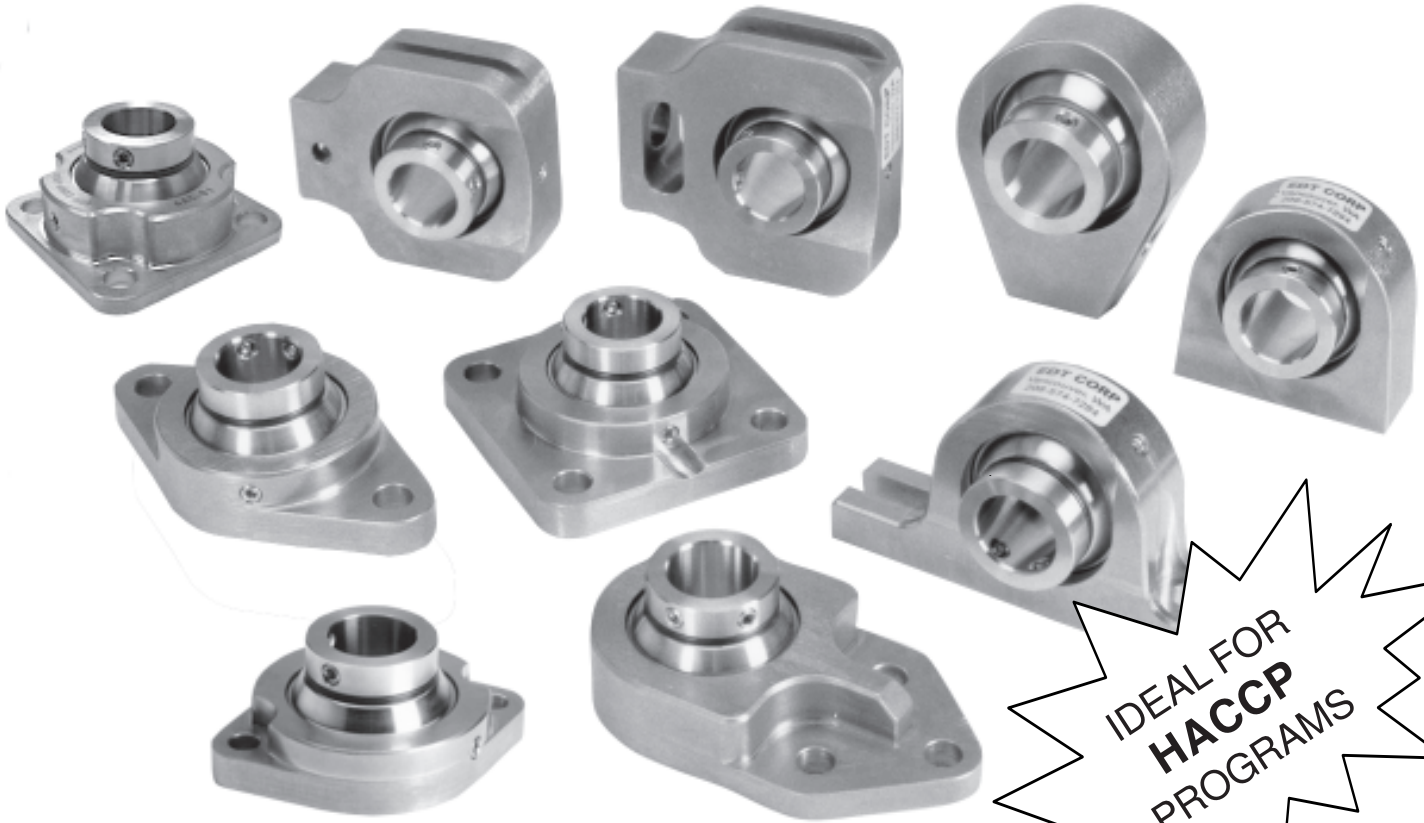

ULTIMATE SOLUTION[®] MOUNTED BEARINGS



IDEAL FOR
HACCP
PROGRAMS

Stainless steel bearing housings with All-Round[®] Supreme bearings

- Stainless steel components are non-corrosive, non-magnetic, abrasion resistant.
- Available for all shaft sizes in all styles.
- Requires no lubrication after installation.
- Major components are a one-time purchase.

edtcorp.com edtsales@edtcorp.com	EDT CORP 1006-J NE 146th Street Vancouver, WA 98685	PHONE 360-574-7294 FAX 360-574-3834
-------------------------------------	--	--